

The Carnaby logo is a red oval with the word "Carnaby" in white, italicized, serif font.

HOLIDAY HOMES OF DISTINCTION  
2024 COLLECTION



# T H E C A R N A B Y S T A N D A R D

The Carnaby Standard encapsulates our brand; the unmistakable quality  
is underfoot, within the walls and visually present.

More than style or a set of features, it's our values - hand woven into the  
fabric of every holiday home we craft.



Why settle for less? Visible or beneath the surface you will instinctively appreciate that your Carnaby is built to the highest standards.

## INTRINSIC QUALITY

Page 12

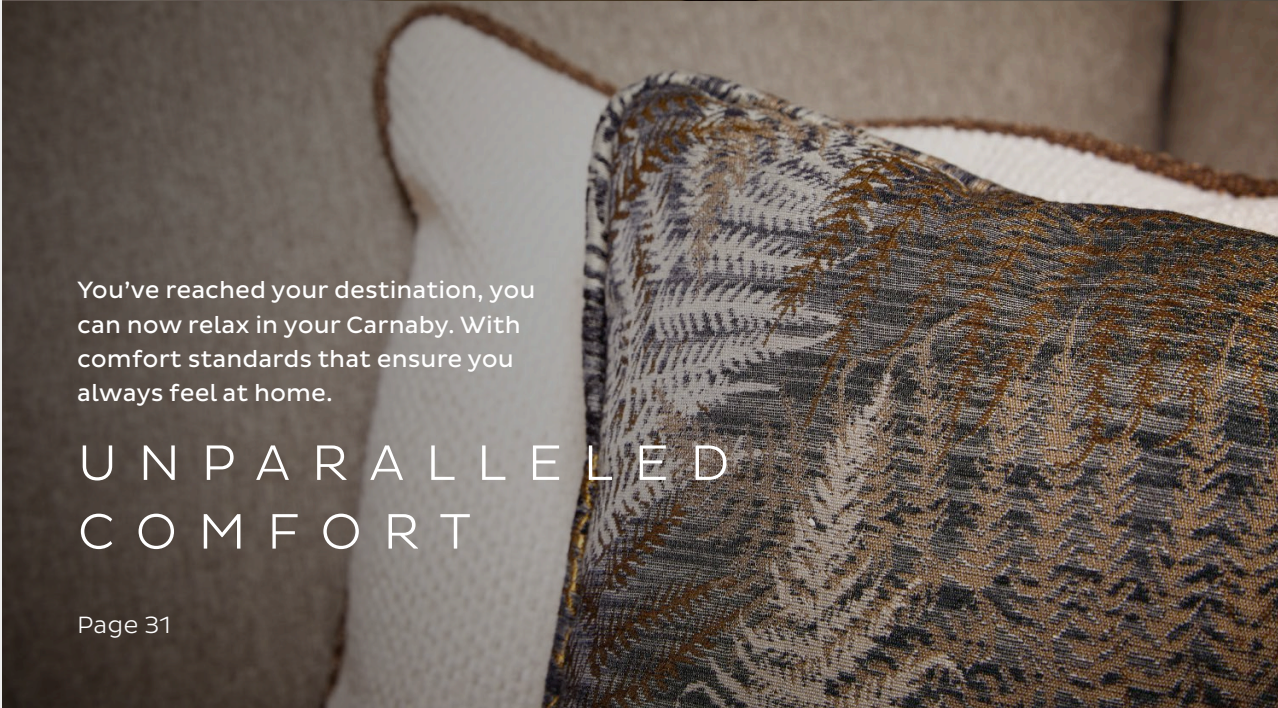

You've reached your destination, you can now relax in your Carnaby. With comfort standards that ensure you always feel at home.

## UNPARALLELED COMFORT

Page 31

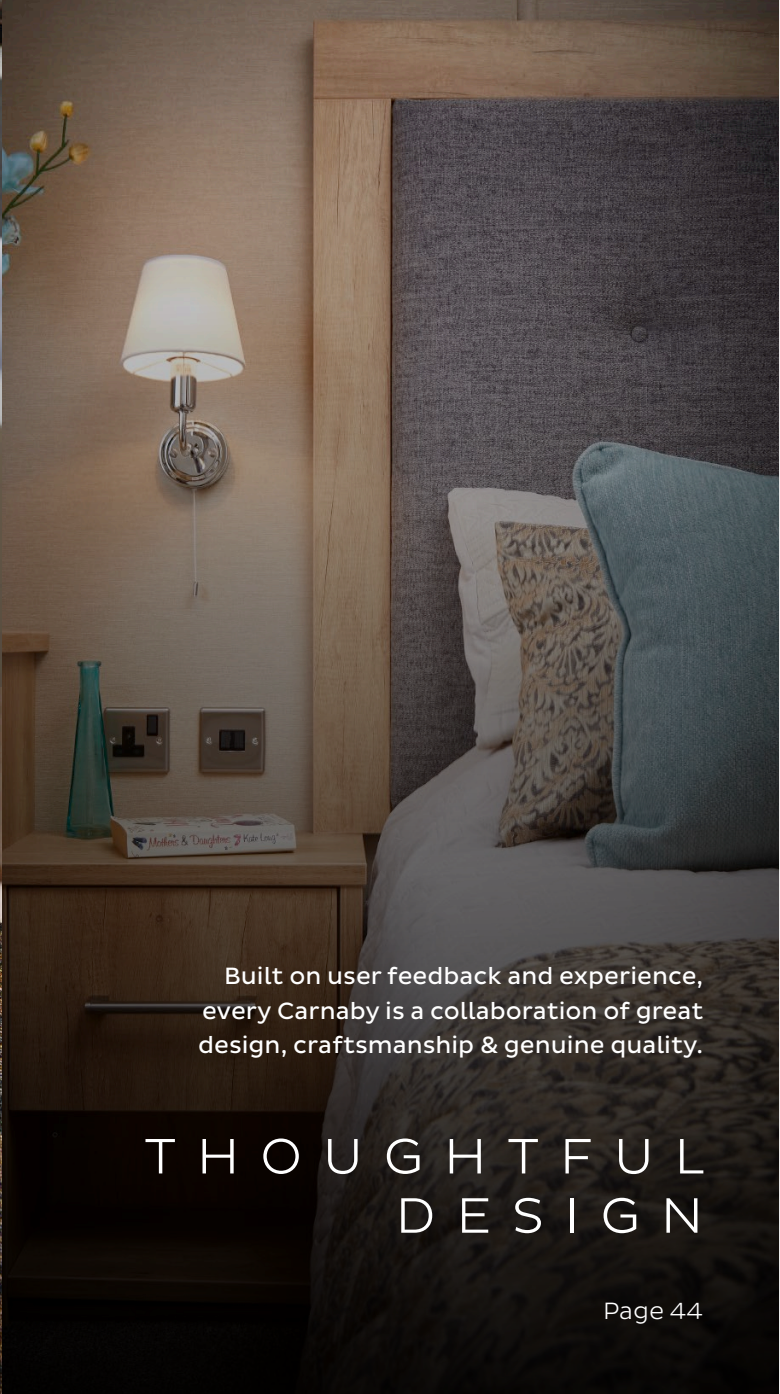

Built on user feedback and experience, every Carnaby is a collaboration of great design, craftsmanship & genuine quality.

## THOUGHTFUL DESIGN

Page 44





## CONTENTS

THE LANGHAM.....	6
CHANTRY LODGE .....	13
GLENMOOR LODGE .....	19
HIGHGROVE .....	25
SILVERDALE .....	32
OAKDALE .....	38
OAKDALE CL.....	45
ASHDALE .....	50
EXTERNAL SIZES.....	56
WARRANTY INFORMATION .....	56
EXTERIOR FINISHES.....	57
WINDOW FINISHES .....	57
SPECIFICATION, FEATURES AND OPTIONS .....	58
STRUCTURAL THERMAL RATING (STR) .....	59



THE LANGHAM



HIGHLIGHT  
Unique 5 star hotel  
central living layout

# THE LANGHAM

## HIGHLIGHT

Feature LED cabinet lighting to kitchen



## HIGHLIGHT

Illuminated mirror backed cocktail cabinet





HIGHLIGHT

Super king bed in both bedrooms



Master Bedroom

THE LANGHAM

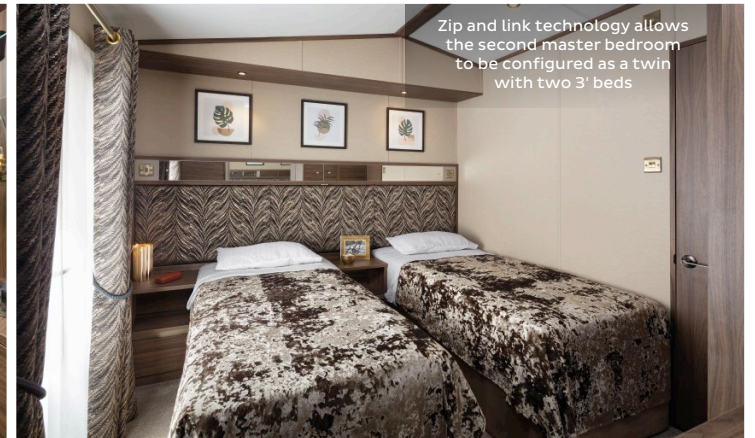



## THE CARNABY STANDARD

- Carnaby Comfort mattresses
- Comfortable ‘Carnaby Sit’ seating
- 7-foot-high walls with vaulted ceilings
- Colour co-ordinated scatter cushions to sofa
- USB charging sockets in lounge and bedrooms
- Externally vented cooker hood extractor
- Exterior lighting to doors
- Voiles to selected windows
- Super soft underlay to all carpeted areas
- Utility storage cupboard

## FEATURES

### EXTERIOR

- Two tone Matt Champagne with Anthracite Grey cladding
- Coloured uPVC double glazing
- Fully galvanised chassis
- Reversible tow bar facility
- Exterior light

### HEATING & INSULATION

- External pipe lagging
- ‘A’ rated Vaillant combi boiler, wet radiators with thermostatic valves
- 50mm fibreglass wall insulation
- 120mm fibreglass roof insulation with vapour barrier
- Double foil under-floor insulation
- uPVC double glazing

### LOUNGE & DINING

- Free standing dining table with padded high back dining chairs
- Corner sofa with scatter cushions
- Bluetooth lounge ceiling speakers
- Wall mounted TV point (HDMI, double mains socket, aerial co-Axial)
- Feature buttoned footstool
- Electric flame effect wood burning stove
- Carnaby crafted cocktail cabinet

### KITCHEN

- Fan assisted electric oven and grill
- Five burner gas hob
- Feature cooker hood extractor
- Integrated microwave oven
- Integrated dishwasher
- Integrated fridge/freezer
- Black resin sink and drainer
- Feature lighting to wall units and under counters
- Venetian blind

### BEDROOMS

- Carnaby Comfort mattresses
- Super King bed in master bedroom
- Super king split base divan with zip-lock mattress to second master bedroom
- Storage beds
- TV points to both bedrooms
- Feature upholstered headboard with bed-side lighting in master bedroom
- Wardrobes, bedside tables, dressing table and stool to both bedrooms
- Bedside USB charging sockets

### BATHROOMS

- Extractor fans to both bathrooms
- Both bathrooms with thermostatically controlled showers
- Heated towel rails to both bathrooms
- Dual sculpted counter top wash basins with vanity unit
- Carnaby crafted cabinets and storage units

## FLOOR PLANS



### 41 X 13 2B

**Bed Sizes:** Super king 1905mm x 1830mm & 2 x Single 1905mm x 915mm which zip and link to make a Super king 1905mm X 1830mm

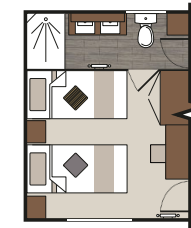

### 41 X 13 2B

**Second Master Bedroom in Twin Configuration**

**M** Microwave **O** Oven **B** Boiler **D** Dishwasher **F** Fridge Freezer **W** Washing Machine\*

\*Optional extra



## STRUCTURAL THERMAL RATING

Rating is based on 41 x 13 - 2B when fitted with optional Ultra Warm Plus.

**For more information see page 59.**

# THE CARNABY STANDARD



## INTRINSIC QUALITY

### HEAD SPACE

Every Carnaby uses space to the maximum. 7-foot-high walls and vaulted ceilings are present across our range, giving you the space to live and entertain without compromise.

### CABINETS & JOINERY

First-class craftsmanship is at the heart of our Holiday Homes. You'll find stylish, well designed, solid furniture, crafted to withstand the rigours of everyday life.

### FIXTURES & FITTINGS

We understand quality. We specify components and fixtures in line with The Carnaby Standard. Flick a switch, draw the curtains or open a drawer knowing time has been taken to ensure every interaction with your holiday home echoes quality.

### QUALITY FEATURES

Appliances you can trust. We specify and fit branded white goods to all our kitchen areas - you will see brands you know and trust from your own home.

### THERMAL RATINGS

Carnaby takes energy efficiency very seriously and by specifying either an Ultra Warm or Ultra Warm Plus upgrade you can celebrate best in industry thermal efficiencies. We only install domestic quality heating systems to keep you warm on a chilly evening and with a flow rate capable of running piping hot water to both showers simultaneously.

# CHANNY LODGE

HIGHLIGHT  
Carnaby crafted wall unit with  
flame effect fire and space  
for up to 65" TV





**HIGHLIGHT**  
Wraparound corner sofa & feature storage footstool



HIGHLIGHT

Elegant deep blue feature kitchen cabinets with brushed gold inlays





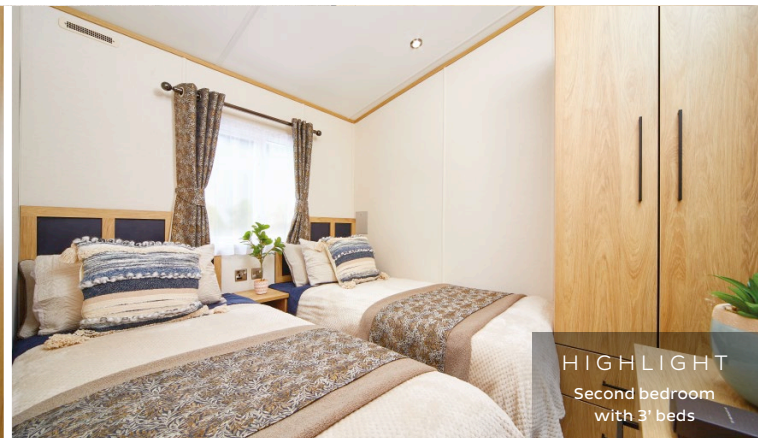
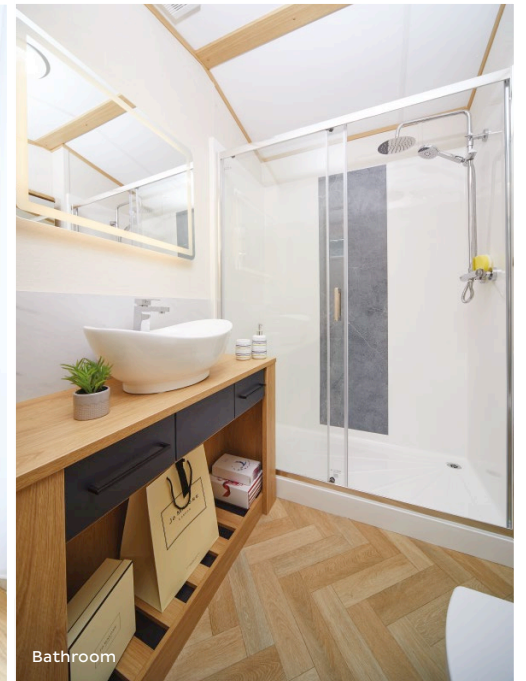



## THE CARNABY STANDARD

- Carnaby Comfort mattresses
- Comfortable 'Carnaby Sit' seating
- 7-foot-high walls with vaulted ceilings
- Colour co-ordinated scatter cushions to sofa
- USB charging sockets in lounge and bedrooms
- Externally vented cooker hood extractor
- Exterior lighting to doors
- Voiles to selected windows
- Super soft underlay to all carpeted areas
- Utility storage cupboard

## FEATURES

### EXTERIOR

- Matt Champagne aluminium cladding
- Fully galvanised chassis
- Reversible tow bar facility
- French doors
- Coloured uPVC double glazing
- Exterior lighting to side and front doors

### HEATING & INSULATION

- External pipe lagging
- 'A' rated Vaillant combi boiler, wet radiators with thermostatic valves
- 50mm fibreglass wall insulation
- 120mm fibreglass roof insulation with vapour barrier
- Double foil under-floor insulation
- uPVC double glazing

### LOUNGE & DINING

- Carnaby crafted wall unit with space for up to 65" TV
- Wraparound corner sofa
- Free standing dining table with padded high back dining chairs
- Feature storage footstool
- Flame effect electric fire

### KITCHEN

- 90cm dual fuel range cooker (gas and electric) with five burner gas hob in 2 bedroom models
- Fan assisted electric oven and grill with five burner gas hob in 3 bedroom model
- Integrated microwave oven
- Integrated dishwasher
- Integrated fridge/freezer
- Black resin sink and drainer
- Dividing door to hallway
- Venetian blind

### BEDROOMS

- Carnaby Comfort mattresses
- King size bed in master bedroom
- 3' beds to second bedroom (two bedroom model only)
- Storage bed with gas strut lift up mechanism (master bedroom only)
- TV points in all bedrooms
- Feature upholstered headboard with bed-side lighting in master bedroom
- Wardrobes, bedside tables and dressing table
- Bedside USB charging sockets

### BATHROOMS

- Extractor fan to both bathrooms
- Family bathroom with a thermostatically controlled shower valve or bath option
- En-Suite bathroom with thermostatically controlled shower
- Heated towel rails to both bathrooms
- Bathroom cabinet with mirror
- Sculpted counter top wash basin with vanity unit
- Venetian blinds in bathroom and en-suite

## FLOOR PLANS

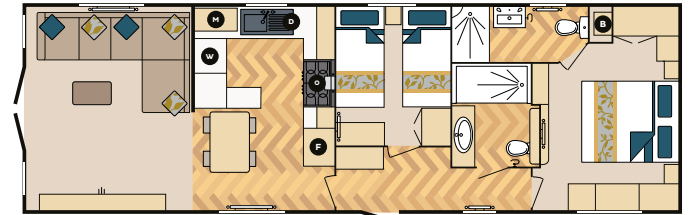

41 X 13 2B - SHOWER

Bed Sizes: King size 1905mm x 1525mm & 2 x Single 1905mm x 915mm

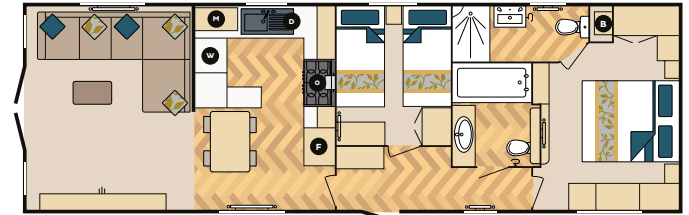

41 X 13 2B - OPTIONAL BATH

Bed Sizes: King size 1905mm x 1525mm & 2 x Single 1905mm x 915mm



41 X 13 3B

Bed Sizes: King size 1905mm x 1525mm, 1 x Single 1830mm x 915mm, 1 x Single 1830mm x 760mm & 2 x Single 1830mm x 685mm

M Microwave O Oven B Boiler D Dishwasher F Fridge Freezer W Washing Machine\*

\*Optional extra



## STRUCTURAL THERMAL RATING

Rating is based on 41 x 13 - 2B when fitted with optional Ultra Warm Plus.

For more information see page 59.



GLENMOOR LODGE



HIGHLIGHT

Panoramic glazed front  
with French doors



**HIGHLIGHT**  
Wraparound feature kitchen with oak doors and grey work surfaces



**HIGHLIGHT**  
Corner sofa and feature accent chair



Feature accent chair & electric flame effect wood burning stove

HIGHLIGHT

King size bed and bed-side lights  
to master bedroom





En Suite



HIGHLIGHT  
3' bed to second bedroom

Second Bedroom



Main Bathroom



Master Bedroom



Master Bedroom





## THE CARNABY STANDARD

- Carnaby Comfort mattresses
- Comfortable 'Carnaby Sit' seating
- 7-foot-high walls with vaulted ceilings
- Colour co-ordinated scatter cushions to sofa
- USB charging sockets in lounge and bedrooms
- Externally vented cooker extractor hood
- Exterior lighting to doors
- Voiles to selected windows
- Super soft underlay to all carpeted areas
- Utility storage cupboard

## FEATURES

### EXTERIOR

- Matt Champagne aluminium cladding
- Fully galvanised chassis
- Reversible tow bar facility
- Panoramic glazing with French Doors
- Exterior lighting to side and front doors

### HEATING & INSULATION

- External pipe lagging
- 25mm Fibreglass wall insulation

### Available with optional Ultra Warm upgrade which includes;

- 'A' rated Vaillant combi boiler, wet radiators with thermostatic valves
- External pipe lagging
- 50mm Fibreglass wall insulation
- 120mm Fibreglass roof insulation with Vapour barrier
- Double foil under-floor insulation
- uPVC double glazing

### LOUNGE & DINING

- Carnaby crafted free-standing TV cabinet
- Wraparound sofa and contrasting chair
- Vertical blinds to glazed front end
- Feature mirror over fireplace
- Free standing dining table with padded high back dining chairs
- Coffee table
- Electric flame effect wood burning stove

### KITCHEN

- Gas oven & grill (twin cavity) with four burner hob
- Integrated microwave oven
- Black resin sink, drainer and mixer tap
- Dividing door to hallway
- Venetian blind

### BEDROOMS

- Carnaby Comfort mattresses
- King size bed to master bedroom
- Storage bed with gas strut lift up mechanism in master bedroom
- TV point in master bedroom
- Bed-side lighting in master bedroom
- Wardrobes, bedside tables and dressing table
- Bedside USB charging sockets

### BATHROOMS

- Extractor fan to both bathrooms
- Thermostatically controlled showers to both bathrooms
- Bathroom cabinet with mirror
- Sculpted counter top wash basin with vanity unit
- Venetian blinds in bathroom and en-suite

## FLOOR PLANS

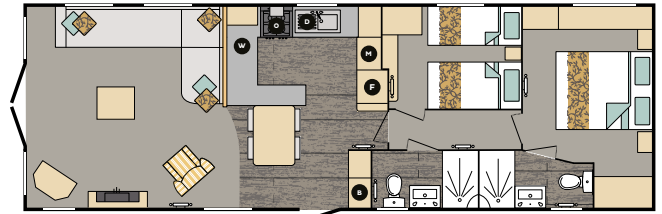

### 40 X 13 2B

Bed Sizes: King size 1905mm x 1525mm,  
1 x Single 1830mm x 915mm & 1 x Single 1830mm x 760mm



### 41 X 13 3B

Bed Sizes: King size 1905mm x 1525mm, 1 x Single 1830mm x 915mm,  
1 x Single 1830mm x 760mm & 2 x Single 1830mm x 685mm

M Microwave O Oven B Boiler D Dishwasher\* F Fridge Freezer W Washing Machine\*

\*Optional extra



## STRUCTURAL THERMAL RATING

Rating is based on 40 x 13 - 2B when fitted with optional Ultra Warm Plus.

For more information see page 59.





H I G H G R O V E

HIGHLIGHT

Freestanding coffee table and TV Unit

Shown with optional French doors





**HIGHLIGHT**  
Large deep-button sofa and  
feature patterned chair





HIGHLIGHT

Kitchen styled with contrasting greys and light oak colour ways





## THE CARNABY STANDARD

- Carnaby Comfort mattresses
- Comfortable 'Carnaby Sit' seating
- 7-foot-high walls with vaulted ceilings
- Colour co-ordinated scatter cushions to sofa
- USB charging sockets in lounge and bedrooms
- Externally vented cooker hood extractor
- Exterior lighting to doors
- Voiles to selected windows
- Super soft underlay to all carpeted areas
- Utility storage cupboard

## FEATURES

### EXTERIOR

- Barley White aluminium cladding
- Reversible tow bar facility
- Panoramic fixed front windows

### HEATING & INSULATION

- External pipe lagging
- 25mm Fibreglass wall insulation

Available with optional Ultra Warm upgrade which includes;

- 'A' rated Vaillant combi boiler, wet radiators with thermostatic valves
- External pipe lagging
- 50mm Fibreglass wall insulation
- 120mm Fibreglass roof insulation with Vapour barrier
- Double foil under-floor insulation
- uPVC double glazing

### LOUNGE & DINING

- Carnaby crafted free-standing TV cabinet
- Large free-standing sofa and contrasting chair
- Feature mirror display shelving
- Free standing dining table with padded high back dining chairs
- Coffee table
- Flame effect electric fire

### KITCHEN

- Gas oven & grill (twin cavity) with four burner hob
- Overhead storage cupboards
- Integrated fridge/freezer
- White one-piece resin sink, drainer with mixer tap
- Dividing door to hallway
- Venetian blind

### BEDROOMS

- Carnaby Comfort mattresses
- King size bed to master bedroom
- Feature mirrors
- TV point in master bedroom
- Feature upholstered headboard with bed-side lighting in master bedroom
- Wardrobes, bedside tables and dressing tables
- Bedside USB charging sockets

### BATHROOMS

- Family bathroom with thermostatically controlled shower
- En-suite bathroom with thermostatically controlled shower (on units over 36')
- Extractor fan to bathroom
- Bathroom cabinet with mirror
- Sculpted counter top wash basin with vanity unit
- Venetian blinds in bathroom and en-suite

## FLOOR PLANS

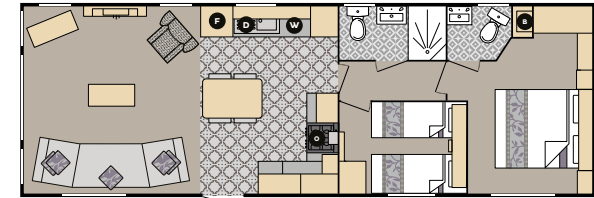

36 X 12 2B

Bed Sizes: King size 1905mm x 1525mm & 2 x Single 1830mm x 685mm

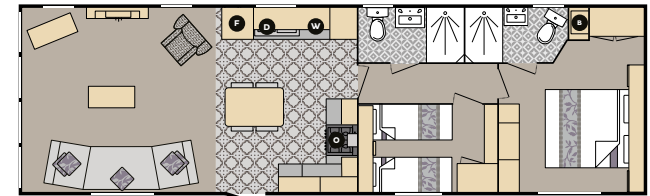

40 X 12 2B

Bed Sizes: King size 1905mm x 1525mm & 2 x Single 1830mm x 685mm

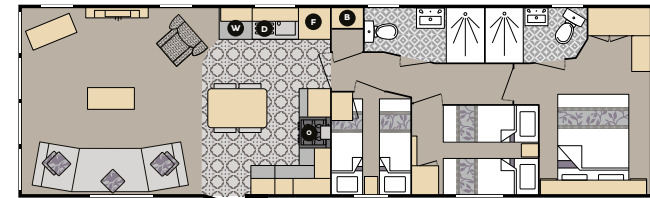

40 X 12 3B

Bed Sizes: King size 1905mm x 1525mm, 2 x Single 1830mm x 685mm & 2 x Single 1830mm x 610mm

O Oven B Boiler D Dishwasher\* F Fridge Freezer W Washing Machine\*

\*Optional extra



## STRUCTURAL THERMAL RATING

Rating is based on 36 x 12 - 2B when fitted with optional Ultra Warm Plus.

For more information see page 59.

## UNPARALLELED COMFORT

### SEATING

Introducing the 'Carnaby Sit'. Our standard ensures every seat in every Carnaby is manufactured to be sumptuous whilst offering industry leading comfort levels.

### COMFORT MATTRESS

Made in the UK to the highest standards, included across the range you'll find the Carnaby Comfort mattress which guarantees a restful night's sleep just as you would expect in your own home.

### FURNISHINGS INCLUDED AS STANDARD

At Carnaby we believe in providing value. Carefully coordinated cushions and window voiles are included, as standard, with every holiday home in our collection.

### FLOORING

Walk into any Holiday Home in our range, kick off your shoes and relax knowing that all carpets have super soft underlay fitted as standard. Within kitchens, bathrooms and en-suites you get springy, soft touch, high quality vinyl flooring.





SILVERDALE



HIGHLIGHT  
Two large, comfortable  
and deep sofas with  
coordinating cushions







Master Bedroom

HIGHLIGHT

King size bed with large headboard, bedside tables and overhead wall cabinets

SILVERDALE





## THE CARNABY STANDARD

- Carnaby Comfort mattresses
- Comfortable 'Carnaby Sit' seating
- 7-foot-high walls with vaulted ceilings
- Colour co-ordinated scatter cushions to sofa
- USB charging sockets in lounge and bedrooms
- Externally vented cooker hood extractor
- Exterior lighting to doors
- Voiles to selected windows
- Super soft underlay to all carpeted areas
- Utility storage cupboard

## FEATURES

### EXTERIOR

- Matt champagne aluminium cladding
- Panoramic fixed front windows
- Reversible tow bar facility
- Exterior lighting to side door

### HEATING & INSULATION

- External pipe lagging
- 25mm Fibreglass wall insulation

### Available with optional Ultra Warm upgrade which includes;

- 'A' rated Vaillant combi boiler, wet radiators with thermostatic valves
- External pipe lagging
- 50mm Fibreglass wall insulation
- 120mm Fibreglass roof insulation with Vapour barrier
- Double foil under-floor insulation
- uPVC double glazing

### LOUNGE & DINING

- Carnaby crafted free-standing TV cabinet
- Two and three seater free-standing sofas
- Carnaby crafted fire surround
- Feature mirror
- Free standing dining table with padded high back dining chairs
- Coffee table
- Flame effect electric fire
- Storage dresser

### KITCHEN

- Gas oven & grill (twin cavity) with four burner hob
- Colour contrasting cabinet doors
- Integrated fridge/freezer
- Textured stainless steel sink, drainer and mixer tap
- Dividing door to hallway
- Venetian blind

### BEDROOMS

- Carnaby Comfort mattresses
- King size bed in master bedroom
- Feature mirrors
- Feature upholstered headboard
- Wardrobes, bedside table and dressing tables
- Bedside USB charging sockets

### BATHROOMS

- Family bathroom with thermostatically controlled shower
- En-suite bathroom with thermostatically controlled shower (on units over 36')
- Bathroom cabinet with mirror
- Floor standing vanity unit with countertop wash basin
- Venetian blinds in bathroom and en-suite

## FLOOR PLANS

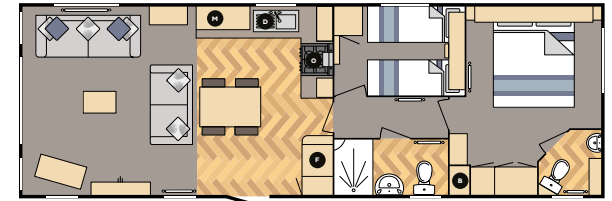

36 X 12 2B

Bed Sizes: King size 1905mm x 1525mm & 2 x Single 1830mm x 685mm

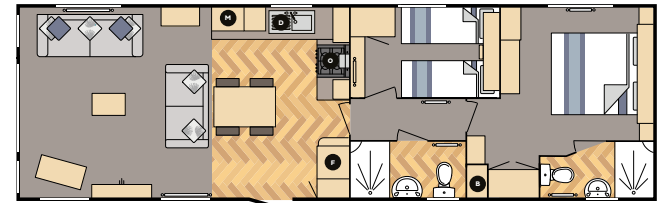

39 X 12 2B

Bed Sizes: King size 1905mm x 1525mm & 2 x Single 1830mm x 685mm

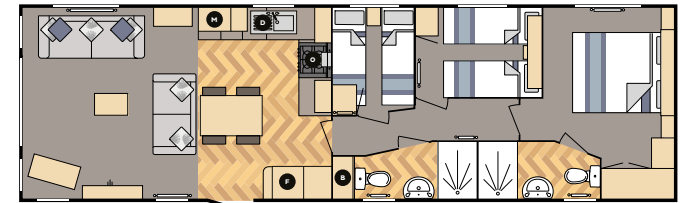

40 X 12 3B

Bed Sizes: King size 1905mm x 1525mm, 2 x Single 1830mm x 685mm & 2x Single 1830mm x 610mm

M Microwave\* O Oven B Boiler D Dishwasher\* F Fridge Freezer

\*Optional extra



## STRUCTURAL THERMAL RATING

Rating is based on 36 x 12 - 2B when fitted with optional Ultra Warm Plus.

For more information see page 59.



OAKDALE

HIGHLIGHT

Fireplace with electric flame effect fire and space to mount a flat screen TV



Shown with optional front door

# OAKDALE





HIGHLIGHT  
Kitchen styled with deep oak timber with pewter accents embedded within the wood grain



# OAKDALE

## HIGHLIGHT

King size bed with coordinating headboard and overhead cabinets



Master Bedroom



Master Bedroom



Second Bedroom



Second Bedroom



Bathroom



## THE CARNABY STANDARD

- Carnaby Comfort mattresses
- Comfortable 'Carnaby Sit' seating
- 7-foot-high walls with vaulted ceilings
- Colour co-ordinated scatter cushions to sofa
- USB charging sockets in lounge and bedrooms
- Externally vented cooker hood extractor
- Exterior lighting to doors
- Voiles to selected windows
- Super soft underlay to all carpeted areas
- Utility storage cupboard

## FEATURES

### EXTERIOR

- Barley White aluminium cladding
- Reversible tow bar facility
- Exterior lighting to side door

### HEATING & INSULATION

- External pipe lagging
- 25mm Fibreglass wall insulation

### Available with optional Ultra Warm upgrade which includes;

- 'A' rated Vaillant combi boiler, wet radiators with thermostatic valves
- External pipe lagging
- 50mm Fibreglass wall insulation
- 120mm Fibreglass roof insulation with Vapour barrier
- Double foil under-floor insulation
- uPVC double glazing

### LOUNGE & DINING

- Carnaby crafted wall unit with inset fire and TV space
- Feature sofa with pull out daybed, adjustable backrests and stools concealed within the arm rest
- Wall mounted TV point (HDMI, single mains socket, aerial co-axial)
- Free standing dining table with padded high back dining chairs
- Coffee table
- Flame effect electric fire
- Aquaclean® technology stain protective coating to sofa fabric

### KITCHEN

- Gas oven & grill (twin cavity) with four burner hob
- Integrated fridge/freezer
- Textured stainless steel sink, drainer and mixer tap
- Dividing door to hallway
- Venetian blind

### BEDROOMS

- Carnaby Comfort mattresses
- Feature mirrors
- Feature upholstered headboard
- Wardrobes, bedside tables and dressing table to master bedroom
- Bedside USB charging sockets

### BATHROOMS

- All showers include thermostatically controlled mixer taps
- Mirrored bathroom cabinet and vanity unit to family shower room
- Bathroom cabinet with mirror to en-suite
- Floor standing vanity unit with countertop wash basin
- Venetian blinds in bathroom and en-suite



## STRUCTURAL THERMAL RATING

Rating is based on 37 x 12 - 2B when fitted with optional Ultra Warm Plus.

For more information see page 59.

## FLOOR PLANS



**28 X 12 2B**  
Bed Sizes: Double 1905mm x 1370mm & 2 x Single 1830mm x 685mm



**32 X 12 2B**  
Bed Sizes: King size 1905mm x 1525mm & 2 x Single 1830mm x 685mm



**35 X 12 2B**  
Bed Sizes: King size 1905mm x 1525mm & 2 x Single 1830mm x 685mm



**36 X 12 3B**  
Bed Sizes: Double 1905mm x 1370mm, 2 x Single 1830mm x 685mm & 2 x Single 1830mm x 610mm



**37 X 12 2B**  
Bed Sizes: King size 1905mm x 1525mm & 2 x Single 1830mm x 685mm



**38 X 12 3B**  
Bed Sizes: King size 1905mm x 1525mm, 2 x Single 1830mm x 685mm & 2 x Single 1830mm x 610mm



Optional front door / window arrangement

- 28 X 12 - 2B
- 32 X 12 - 2B
- 35 X 12 - 2B
- 36 X 12 - 3B
- 37 X 12 - 2B
- 38 X 12 - 3B

- M Microwave\*
- O Oven
- B Boiler
- D Dishwasher\*
- F Fridge Freezer

\*Optional extra

# THE CARNABY STANDARD



## THOUGHTFUL DESIGN

### COOK UP A STORM

Experience entertaining in well thought-out living spaces. Every Carnaby, at every price point, features an externally vented cooker hood as standard.

### LIFE IN COLOUR

Our design team takes the time to ensure thoughtful use of colour, pattern and tone - defining and connecting spaces throughout your holiday home.

### CHARGING

Wall mounted USB enabled charging sockets are positioned in convenient locations so you can continue working or playing with uninterrupted power.

### STORAGE

Attention to every detail. Located centrally in Carnaby Holiday Homes you'll find a convenient storage cupboard for hanging your coats and walking boots.

### GUIDING LIGHT

After a fun day out, be welcomed back to your door. As standard we fit a feature side light to every holiday home in our range. Useful for finding your keys or spending a few extra twilight hours enjoying your outdoor space.



OAKDALE CENTRE LOUNGE

HIGHLIGHT

Central living layout  
with bedrooms  
at both ends



HIGHLIGHTS

The optional Vision Pack conceals the TV behind the fireplace and gives an extra window to let light flood in.

Feature sofa with pull out daybed, adjustable backrests and stools concealed within the arm rest



Shown with optional Vision Pack



**HIGHLIGHT**  
Kitchen finished in deep oak timber with pewter accents embedded within the wood grain.



Adjustable backrests.



**HIGHLIGHT**  
Utility area in the 2 bedroom model

# OAKDALE CENTRE LOUNGE



## HIGHLIGHT

King size bed with coordinating headboard and overhead cabinets



Master Bedroom

Bathroom with feature wall board



En-suite



Master Bedroom



Second Bedroom





## THE CARNABY STANDARD

- Carnaby Comfort mattresses
- Comfortable ‘Carnaby Sit’ seating
- 7-foot-high walls with vaulted ceilings
- Colour co-ordinated scatter cushions to sofa
- USB charging sockets in lounge and bedrooms
- Externally vented cooker hood extractor
- Exterior lighting to doors
- Voiles to selected windows
- Super soft underlay to all carpeted areas
- Utility storage cupboard

## FEATURES

### EXTERIOR

- Barley White aluminium cladding
- Reversible tow bar facility
- French doors
- Exterior lighting to door

### HEATING & INSULATION

- External pipe lagging
- 25mm Fibreglass wall insulation

### Available with optional Ultra Warm upgrade which includes;

- ‘A’ rated Vaillant combi boiler, wet radiators with thermostatic valves
- External pipe lagging
- 50mm Fibreglass wall insulation
- 120mm Fibreglass roof insulation with Vapour barrier
- Double foil under-floor insulation
- uPVC double glazing

### LOUNGE & DINING

- Carnaby crafted wall unit with inset fire and TV space
- Feature sofa with pull out daybed, adjustable backrests and stools concealed within the arm rest
- Wall mounted TV point (HDMI, Single mains socket, aerial co-axial)
- Free-standing dining table with padded high back dining chairs
- Coffee table
- Flame effect electric fire
- Optional vision pack reveal TV and extra window
- Aquaclean® technology stain protective coating to sofa fabric

### KITCHEN

- Gas oven & grill (twin cavity) with four burner hob
- Integrated fridge/freezer
- Textured stainless steel sink, drainer and mixer tap
- Venetian blind

### BEDROOMS

- Carnaby Comfort mattresses
- King size bed in master bedroom
- Feature mirrors
- Feature upholstered headboard
- Wardrobes, bedside tables and dressing table to main bedroom
- Bedside USB charging sockets
- 3’ beds to 2nd bedroom\* (\*2 bedroom model only)

### BATHROOMS

- All showers include thermostatically controlled mixer taps
- Bathroom cabinet with mirror to en-suite and family washrooms
- Floor standing vanity unit with countertop porcelain wash basin
- Venetian blinds in bathroom and en-suite

## FLOOR PLANS



38 X 12 2B

Bed Sizes: King size 1905mm x 1525mm & 2 x Single 1830mm x 915mm



39 X 12 3B

Bed Sizes: King size 1905mm x 1525mm, 2 x Single 1830mm x 685mm & 2 x 1830mm x 760mm

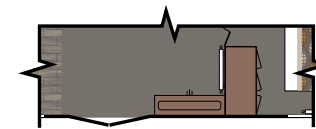

CL VISION PACK

O Oven   B Boiler   D Dishwasher\*   F Fridge Freezer   W Washing Machine\*

\*Optional extra



## STRUCTURAL THERMAL RATING

Rating is based on 39 x 12 - 3B when fitted with optional Ultra Warm Plus.

For more information see page 59.

The background is a solid teal color with a repeating pattern of stylized, elongated leaves. Each leaf is outlined in a darker teal and filled with fine, parallel lines that create a textured, woven appearance. The leaves are scattered across the page, some overlapping, and are oriented in various directions.

# A S H D A L E

HIGHLIGHT

Comfortable 'Carnaby Sit'  
fitted corner sofa



ASHDALE



HIGHLIGHT

Kitchen styled with terrazzo style counters, light grey doors & light timber accents.



ASHDALE



Master Bedroom



Master Bedroom



Second Bedroom



Bathroom



Bathroom



## THE CARNABY STANDARD

- Carnaby Comfort mattresses
- Comfortable ‘Carnaby Sit’ seating
- 7-foot-high walls with vaulted ceilings
- Colour co-ordinated scatter cushions to sofa
- USB charging sockets in lounge and bedrooms
- Externally vented cooker hood extractor
- Exterior lighting to doors
- Voiles to selected windows
- Super soft underlay to all carpeted areas
- Utility storage cupboard

## FEATURES

### EXTERIOR

- Barley White aluminium cladding
- Reversible tow bar facility
- Exterior lighting to side door

### HEATING & INSULATION

- External pipe lagging
- 25mm Fibreglass wall insulation

### Available with optional Ultra Warm upgrade which includes;

- ‘A’ rated Vaillant combi boiler, wet radiators with thermostatic valves
- External pipe lagging
- 50mm Fibreglass wall insulation
- 120mm Fibreglass roof insulation with Vapour barrier
- Double foil under-floor insulation
- uPVC double glazing

### LOUNGE & DINING

- Carnaby crafted wall unit with inset fire and TV space
- Wraparound fixed sofa with concealed storage
- Free-standing dining table and chairs
- Flame effect electric fire
- USB charging sockets in lounge

### KITCHEN

- Gas oven & grill (twin cavity) with four burner hob
- Integrated fridge/freezer
- Textured stainless steel sink, drainer and mixer tap
- Venetian blind

### BEDROOMS

- Carnaby Comfort mattresses
- Feature mirrors
- Coordinated upholstered headboard
- Wardrobes, bedside tables and dresser
- Bedside USB charging sockets

### BATHROOMS

- Family bathroom with thermostatically controlled shower
- Bathroom cabinet with mirror to family bathroom and en-suite
- Porcelain pedestal wash basins
- Venetian blinds in bathroom and en-suite

## FLOOR PLANS

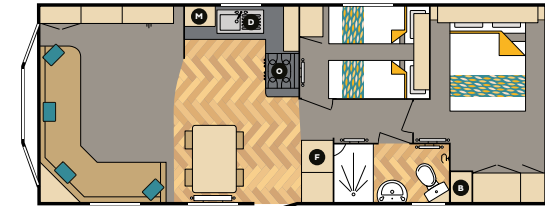

30 X 12 2B

Bed Sizes: Double 1905mm x 1370mm & 2 x Single 1830mm x 685mm

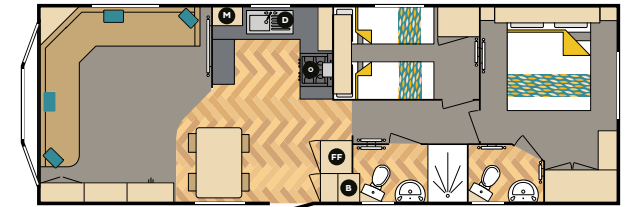

35 X 12 2B

Bed Sizes: King size 1905mm x 1525mm, 2 x Single 1830mm x 685mm

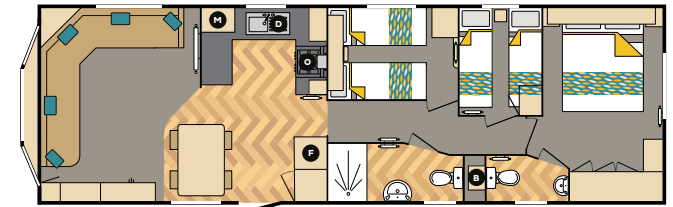

38 X 12 3B

Bed Sizes: King size 1905mm x 1525mm, 2 x Single 1830mm x 685mm & 2 x Single 1830mm x 610mm

M Microwave\* O Oven B Boiler D Dishwasher\* F Fridge Freezer

\*Optional extra



## STRUCTURAL THERMAL RATING

Rating is based on 35 x 12 - 2B when fitted with optional Ultra Warm Plus.

For more information see page 59.

## EXTERNAL SIZES



**KEY** All dimensions expressed in metres (m)

- |   |   |
|---|---|
| <b>L1</b> Overall length including tow bar          | <b>W1</b> Overall width including gutters |
| <b>L2</b> Overall roof length including gutters     | <b>W2</b> Overall body width              |
| <b>L3</b> Body length including bay (if applicable) | <b>H1</b> Overall height including flues  |
| <b>L4</b> Body length at floor level                | <b>H2</b> Height to ridge                 |

## WARRANTY

Our comprehensive warranty offers protection for your investment and gives you peace of mind.

### GET PEACE OF MIND GUARANTEED



All Carnaby caravans are covered by a minimum 12 months parts and labour warranty\* from the date of purchase by the first owner.



- Fully Galvanised Chassis



- Painted Chassis
- Double Glazed units in windows & Exterior Doors (Excluding Frames, Handles and Hinges)
- Pan Tile Roof Sheets
- Walls, Ceilings & Floors



- Boilers (Vaillant)
- Electric Fires
- Electric Sockets & Switches
- Free Standing Furniture
- Taps
- Washbasins & Sanitaryware
- Radiators & Towel Rails\*\*
- Kitchen Sink
- Interior Door Handles
- Gutters, Downpipes & Cladding



- Fridge-Freezers, Microwaves, Cooker Hoods & Dishwashers

\* Excluding any damage caused by transport, siting, commissioning, general wear and tear or misuse. Warranty only applies to original purchaser and is non transferable. \*\* Only a 1 year warranty is provided for radiators positioned in shower rooms and toilets.

	L1	L2	L3	L4	W1	W2	H1	H2	Weight (KG)
<b>ASHDALE</b>									
30 x 12 2B	10.35	9.66	9.55	9.25	4	3.68	3.47	3.47	3820
35 x 12 2B	11.77	11.08	10.97	10.67	4	3.68	3.47	3.47	4230
38 x 12 3B	12.78	12.09	11.98	11.68	4	3.68	3.47	3.47	4775
<b>OAKDALE</b>									
28 x 12 2B	9.74	9.05	8.94	8.64	4	3.68	3.47	3.47	3910*
32 x 12 2B	11.01	10.32	10.21	9.91	4	3.68	3.47	3.47	4360*
35 x 12 2B	11.89	11.2	11.09	10.79	4	3.68	3.47	3.47	4530*
36 x 12 3B	12.18	11.49	11.38	11.08	4	3.68	3.47	3.47	4710*
37 x 12 2B	12.49	11.8	11.69	11.39	4	3.68	3.47	3.47	4780*
38 x 12 3B	12.78	12.09	11.98	11.68	4	3.68	3.47	3.47	5050*
<b>OAKDALE CL</b>									
38 x 12 2B	12.71	11.81	N/A	11.61	4	3.68	3.47	3.47	4920*
39 x 12 3B	13.01	12.11	N/A	11.91	4	3.68	3.47	3.47	4960*
<b>SILVERDALE</b>									
36 x 12 2B	11.92	11.33	N/A	11.02	4	3.68	3.47	3.47	4510*
39 x 12 2B	12.84	12.25	N/A	11.94	4	3.68	3.47	3.47	5150*
40 x 12 3B	13.14	12.55	N/A	12.24	4	3.68	3.47	3.47	5200*
<b>HIGHGROVE</b>									
36 x 12 2B	12.03	11.54	N/A	11.13	4	3.68	3.47	3.47	4700*
40 x 12 2B	13.1	12.61	N/A	12.2	4	3.68	3.47	3.47	5350*
40 x 12 3B	13.2	12.71	N/A	12.3	4	3.68	3.47	3.47	5500*
<b>GLENMOOR LODGE</b>									
40 x 13 2B	13.4	12.71	N/A	12.3	4.3	3.98	3.57	3.57	5830*
41 x 13 3B	13.66	12.97	N/A	12.56	4.3	3.98	3.57	3.57	5810*
<b>CHANTRY LODGE</b>									
41 x 13 2B	13.6	12.91	N/A	12.5	4.3	3.98	3.57	3.57	6060*
41 x 13 3B	13.6	12.91	N/A	12.5	4.3	3.98	3.57	3.57	5620*
<b>THE LANGHAM</b>									
41 x 13 2B	13.66	12.76	N/A	12.56	4.3	3.98	3.57	3.57	5630*

\* For Timber and CanExel cladding add 500Kg.

All model weights are inclusive of wet radiator heating systems. All dimensions are in metres.



# EXTERIOR FINISHES

We have a range of exterior colours and finishes to suit you and your surroundings. Where options allow, holiday homes can be clad in Aluminium, Embossed Plastic, CanExel or Timber.

## ALUMINIUM



MATT CHAMPAGNE PLANK

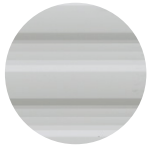

MATT CHAMPAGNE AB PROFILE



BARLEY WHITE AB PROFILE



ENVIRONMENTAL GREEN

## EMBOSSSED PLASTIC



CREAM



SAND

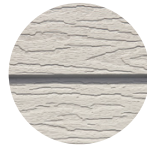

STONE

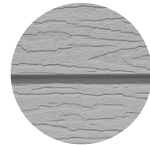

GREY



ENVIRONMENTAL GREEN

## CANEXEL



BARNWOOD



CLIFFSIDE



COASTLINE



MIST GREY



SAND

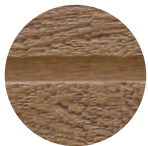

SIERRA

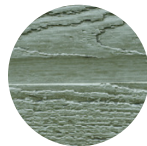

ACADIA ENVIRONMENTAL

## TIMBER\*



TIMBER EUROPEAN REDWOOD

### KEY

Standard S  
Optional O  
Not Available X

	ASHDALE	OAKDALE	OAKDALE CL	SILVERDALE	HIGHGROVE	GLENMOOR LODGE	CHANTRY LODGE	LANGHAM
MATT CHAMPAGNE PLANK	X	X	X	X	X	S	S	S
MATT CHAMPAGNE AB PROFILE	X	X	X	S	X	X	X	X
BARLEY WHITE AB PROFILE	S	S	S	X	S	X	X	X
ENVIRONMENTAL GREEN	O	O	O	O	O	O	O	O
CREAM	X	O	O	O	O	O	O	O
SAND	X	O	O	O	O	O	O	O
STONE	X	O	O	O	O	O	O	O
GREY	X	O	O	O	O	O	O	O
ENVIRONMENTAL GREEN	X	O	O	O	O	O	O	O
BARNWOOD	X	O	O	O	O	O	O	O
CLIFFSIDE	X	O	O	O	O	O	O	O
COASTLINE	X	O	O	O	O	O	O	O
COASTLINE	X	O	O	O	O	O	O	O
SAND	X	O	O	O	O	O	O	O
SIERRA	X	O	O	O	O	O	O	O
ACADIA ENVIRONMENTAL	X	O	O	O	O	O	O	O
TIMBER EUROPEAN REDWOOD*	X	O	O	O	O	O	O	O

\*Samples are available on request

## WINDOW FINISHES

To complement your choice of exterior cladding colour we offer a wide range of uPVC window options.



ANTIQUE



GOLDEN OAK



GREEN



GREY  
Standard on The Langham and Chantry Lodge

# SPECIFICATIONS, FEATURES AND OPTIONS

## KEY

Standard	S
Optional	O
Not Available	X

## EXTERIOR

	THE LANGHAM	CHANTRY LODGE	GLENMOOR LODGE	HIGHROVE	SILVERDALE	OAKDALE	OAKDALE CL	ASHDALE
Aluminium Cladding	S	S	S	S	S	S	S	S
Plastic Cladding	O	O	O	O	O	X <sup>1</sup>	O	X
CanExel Cladding	O	O	O	O	O	X <sup>1</sup>	O	X
Timber Cladding	O	O	O	O	O	X <sup>1</sup>	O	X
Environmental Colours (Cladding and Glazing)	O	O	O	O	O	O	O	O
Coloured uPVC Glazing	S	S	O	O	O	O	O	O
Painted Chassis with Pre-Galvanised Legs	X	X	X	S	S	S	S	S
Fully Galvanised Chassis	S	S	S	O	O	O	O	O
Reversible Tow Bar Facility	S	S	S	S	S	S	S	S
uPVC Double Glazing	S	S	O	O	O	O	O	O
Exterior Light	S	S	S	S	S	S	S	S
Single Front Door	X	X	X	X	X	O	X	X
French Doors	O	S	S	O	O	X	S	X
'Velux' Roof Window	O	O	O	O	O	O	O	O
Vision Pack Including Remote Reveal Television	X	X	X	X	X	X	O	X

## HEATING & INSULATION

External Pipe Lagging	S	S	S	S	S	S	S	S
25mm Fibreglass Wall Insulation	X	X	S	S	S	S	S	S
Ultra Warm Upgrade	S	S	O	O	O	O	O	O
Ultra Warm Plus Upgrade	O	O	O	O	O	O	O	O
Trace Heating	O	O	O	O	O	O	O	O
BS3632 Residential Specification, includes uPVC Plastic Cladding	O	O	O	X	X	X	X	X
Electric Panel Heaters	O	O	O	O	O	O	O	O

## LOUNGE & DINING

	THE LANGHAM	CHANTRY LODGE	GLENMOOR LODGE	HIGHROVE	SILVERDALE	OAKDALE	OAKDALE CL	ASHDALE
Net Curtains/Voile on Selected Windows	S	S	S	S	S	S	S	S
Carpet Underlay	S	S	S	S	S	S	S	S
Aquaclean® stain protective coating to sofa fabric	X	X	X	X	X	S	S	X
Dining Table & Chairs	S	S	S	S	S	S	S	S
Additional Dining Chair	O	O	O	O	O	O	O	O
USB Charging Sockets in Lounge	S	S	S	S	S	S	S	S
Dining Stool	O	O	O	O	O	S	S	O
Bluetooth Lounge Ceiling Speakers	S	O	O	O	O	O	O	O
Wall Mounted TV Point (HDMI, Mains Socket, Aerial Co-Axial)	S	O	O	X	O	S	S	O
Make-up Bed in Lounge	X	X	O	X	X	S	S	O
Air-Divan	O	O	O	O	O	O	O	O
Lounge Scatter Cushions	S	S	S	S	S	S	S	S
Coffee Table	S	S	S	S	S	S	S	O

## KITCHEN

Electric Fan Assisted Oven and Grill (Single Cavity)	S	S <sup>4</sup>	X	X	X	X	X	X
90cm Dual Fuel Range Cooker	X	S <sup>5</sup>	X	X	X	X	X	X
Five Burner Gas Hob	S	S <sup>4</sup>	X	X	X	X	X	X
Externally Vented Cooker Hood Extractor	S	S	S	S	S	S	S	S
Gas Oven & Grill (Twin Cavity) & Four Burner Hob	X	X	S	S	S	S	S	S
Free-standing Microwave Oven	X	X	X	O	O	O	O	O
Integrated Microwave Oven	S	S	S	X	O	O	X	O
Integrated Dishwasher	S	S	O	O	O	O	O	O
Integrated Fridge/Freezer	S	S	S	S	S	S	S	S
Plinth Lighting	O	O	O	O	O	O	O	O
Dividing Door to Hallway	X	S	S	S	S	S	X	O
Integrated Washing Machine	O <sup>2</sup>	O <sup>2</sup>	O	O	X	X	O	X
Integrated Washer/Dryer	O <sup>2</sup>	O <sup>2</sup>	O	O	X	X	O	X

	THE LANGHAM	CHANTRY LODGE	GLENMOOR LODGE	HIGHGROVE	SILVERDALE	OAKDALE	OAKDALE CL	ASHDALE
<b>KEY</b>								
Standard	S							
Optional	O							
Not Available	X							

**BEDROOMS**

Bedding Set (Duvet Covers, Pillow Cases & Runners)	O	O	O	O	O	O	O	O
Tufttained Mattress (Single)	O	O	O	O	O	O	O	O
Tufttained Mattress (Double)	O	O	O	O	O	O	O	O
Gas Strut Lift Up Storage Bed (Master Bedroom Only)	X	S	S	O	O	O	O	O
Space Saving Fold Under Bed (Second Bedrooms Only)	X	O	O	O	O	O	O	O
Divan Beds With Under Bed Storage	S	X	X	X	X	X	X	X
Mosquito Nets & Blinds (Bedroom windows only)	X	O	O	O	O	O	O	O
USB Charging Sockets in Bedrooms	S	S	S	S	S	S	S	S
TV Aerial Booster	O	O	O	O	O	O	O	O
TV Point in Main Bedroom	S	S	S	S	O	O	O	O
TV Point in Second Bedroom	S	S	O	O	O	O	O	O
TV Point in Third Bedroom	X	S	O	O	O	O	O	O

**BATHROOMS**

Extractor Fan to shower bathroom (s)	S	S	S	S	S	S	S	S
Family Bathroom with Shower	S	S	S	S	S	S	S	S
En-suite Bathroom with Shower	S	S	S	S <sup>*3</sup>	S <sup>*3</sup>	X	S	X
Family Bathroom with Bath	X	O <sup>*5</sup>	X	X	X	X	X	X

\*1) Available on Oakdale when front door option is selected  
 \*2) Plumbing and electrics fitted as standard  
 \*3) Not available on Highgrove - 36 x 12 2B or Silverdale - 36 x 12 2B  
 \*4) 3 Bedroom Model Only  
 \*5) 2 Bedroom Model Only

**ENERGY SAVING STANDARDS**

Comfort comes in many forms which is why we've invested in the insulation properties of all our holiday homes.

Carnaby's research and development team have focused on the insulation values of the walls, floors, ceilings and windows - improving comfort levels and saving energy in all our Holiday Homes fitted with our Ultra Warm or Ultra Warm Plus options.

**ULTRA WARM UPGRADE**



- ✓ Wet System Radiators with Thermostatic Radiator Valves
- ✓ 50mm Fibreglass Wall Insulation
- ✓ 120mm Roof Insulation with Vapour Barrier
- ✓ Double Foil Under-Floor Insulation
- ✓ uPVC Double Glazing

**ULTRA WARM PLUS UPGRADE**



- ✓ Wet System Radiators with Thermostatic Radiator Valves
- ✓ 50mm High Density Fibreglass Wall Insulation
- ✓ 100mm High Density Roof Insulation with Vapour Barrier
- ✓ Double Foil Under-Floor Insulation +25mm Fibreglass
- ✓ uPVC Double Glazing 'Low E' Glass Argon filled

The NCC Structural Thermal Rating Scheme is designed to give purchasers of caravan holiday homes built to EN 1647 the opportunity to compare the relative thermal efficiency between all manufacturers and their models on a level playing field.



**STRUCTURAL THERMAL RATINGS (STR)**



ASHDALE		
30 x 12 2B	8.3	8.8
35 x 12 2B	8.4	8.9
38 x 12 3B	8.5	8.9
OAKDALE		
28 x 12 2B	8.1	8.6
32 x 12 2B	8.2	8.8
35 x 12 2B	8.3	8.8
36 x 12 3B	8.3	8.8
37 x 12 2B	8.4	8.9
38 x 12 3B	8.4	8.9
OAKDALE CL		
38 x 12 2B	8.4	8.9
39 x 12 3B	8.4	8.9
SILVERDALE		
36 x 12 2B	8.3	8.9
39 x 12 2B	8.2	8.8
40 x 12 3B	8.3	8.8
HIGHGROVE		
36 x 12 2B	8.3	8.9
40 x 12 2B	8.3	8.9
40 x 12 3B	8.3	8.9
GLENMOOR LODGE		
40 x 13 2B	8.4	9
41 x 13 3B	8.4	9
CHANTRY LODGE		
41 x 13 2B	8.5	9
41 x 13 3B	8.5	9
THE LANGHAM		
41 x 13 2B	8.5	9

## DISCLAIMER

Table settings, ornaments, toys, electrical appliances, duvet covers and pillowcases as displayed are intended for photographic purposes only and, unless otherwise specified in writing, do not form any part of any contract, nor do they constitute any representation whatsoever by us or on behalf of Carnaby Caravans Ltd. All dimensions are approximate sizes. Carnaby reserves the right to change any materials, fittings etc, shown in this brochure without prior notice in accordance with our policy of continual improvement or availability of material. All Carnaby holiday homes are built to grade B snow-loading in accordance with EN1647. The model designated size does not denote the body length or width. All Carnaby holiday homes must be connected to mains water, sewerage, electricity, and propane gas (unless otherwise specified).

Caravan holiday homes are designed to provide comfortable, high-quality accommodation for holiday and recreational use only; recreational use should be considered to include holidays of not more than six weeks of continuous use, weekend visits, and other short duration visits. They are not designed for residential occupancy.

Caravan holiday homes are built to the EN1647 specification. If you are looking to live in a caravan holiday home or stay in one for non-recreational use you should consider purchasing a residential park home which is sited on a residential park home estate. If the above advice is not followed and your caravan holiday home is used as a main residence then the manufacturer's warranty may be compromised.

The Langham, Chantry Lodge and Glenmoor Lodge are, as an optional extra, available in BS3632 which has the advantage of 0% VAT on the construction element. Please refer to the Park Licence and associated planning conditions when selecting either a holiday home EN1647 or a BS3632 residential specification unit.

We have made every effort to make the colours and finishes printed in this brochure as close as possible to the colours and finishes of our caravan exteriors and contents. However, we cannot guarantee an exact match in colours and finishes and the images in this brochure should not be relied on as such. The representation of colours are limited by technology and may vary due to the printing process.



HOLIDAY HOMES OF DISTINCTION

# 2024 COLLECTION

DEALER / PARK OPERATOR STAMP



PLEASE ASK YOUR DEALER OR PARK TO CONFIRM PRICES

For product information call: 01262 679971  
For general enquiries email: [info@carnabycaravans.com](mailto:info@carnabycaravans.com)  
For sales enquiries email: [sales@carnabycaravans.com](mailto:sales@carnabycaravans.com)



## CARNABY CARAVANS LIMITED

Lancaster Road, Carnaby Industrial Estate, Bridlington,  
East Riding of Yorkshire YO15 3QY

Call 01262 679971 [www.carnabycaravans.com](http://www.carnabycaravans.com)