



St. Hermans Caravan Estate, HAYLING ISLAND, Hampshire
Asking Price: £140,000

Morris Dibben







This wonderful Tingdene Hayden Classic, 32' x 10' static mobile home has one bedroom, is being sold with no onward chain and situated in a popular and private residential estate. Within half a mile of local shops and the plaza at Eastoke Corner and three quarters of a mile from Mengham Village and The Health Centre this property is well positioned for access to amenities. The accommodation is in excellent condition throughout after being modernised by the current owners and comprises; entrance porch, an inner hall way, a bright and airy living room/diner with double doors to the garden which is semi-open plan with a fitted kitchen, a double bedroom with fitted wardrobes, a modern shower room and private garden facing south westerly aspects. There is also off road parking to the front with access to the rear garden.



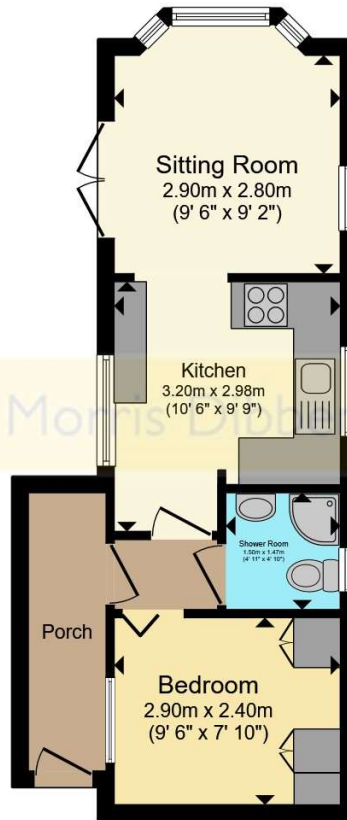

Total floor area 32.4 m² (349 sq.ft.) approx

This floor plan is for illustrative purposes only. It is not drawn to scale. Any measurements, floor areas (including any total floor area), openings and orientation are approximate. No details are guaranteed, they cannot be relied upon for any purpose and they do not form part of any agreement. No liability is taken for any error, omission or misstatement. A party must rely upon its own inspection(s). Powered by www.focalagent.com



Council Tax Band: **TBC**

Pitch Fees: **£1,878**

Viewing by appointment

T: 023 9246 5941

E: haylingisland@morrisdibben.co.uk

2 Elm Grove, Hayling Island, Hampshire, PO11 9EF



Interested parties should satisfy themselves, by inspection or otherwise as to the accuracy of the description given and any floor plans shown in these property details. All measurements, distances and areas listed are approximate. Fixtures, fittings and other items are NOT included unless specified in these details. Please note that any services, heating systems, or appliances have not been tested and no warranty can be given or implied as to their working order.

Morris Dibben is a trading name of Countrywide Estate Agents, Registered in England Number 00789476. Registered Office Greenwood House, 1st Floor, 91-99 New London Road, Chelmsford, Essex, CM2 0PP. VAT number 500 2481 05

Code: PHI_PHI240189_R6PL_8

Morris Dibben